

2. SRI AMAN AGARWAL S/O SRI HARISH KUMAR AGARWAL,
SEVOKE ROAD BY LANE, BANKIM NAGAR, P.O. & P.S.-SILIGURI,
DIST - JALPAIGURI, WARD NO. 41 (S.M.C.)

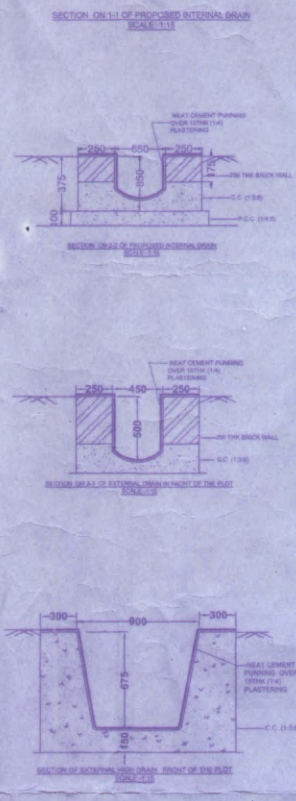
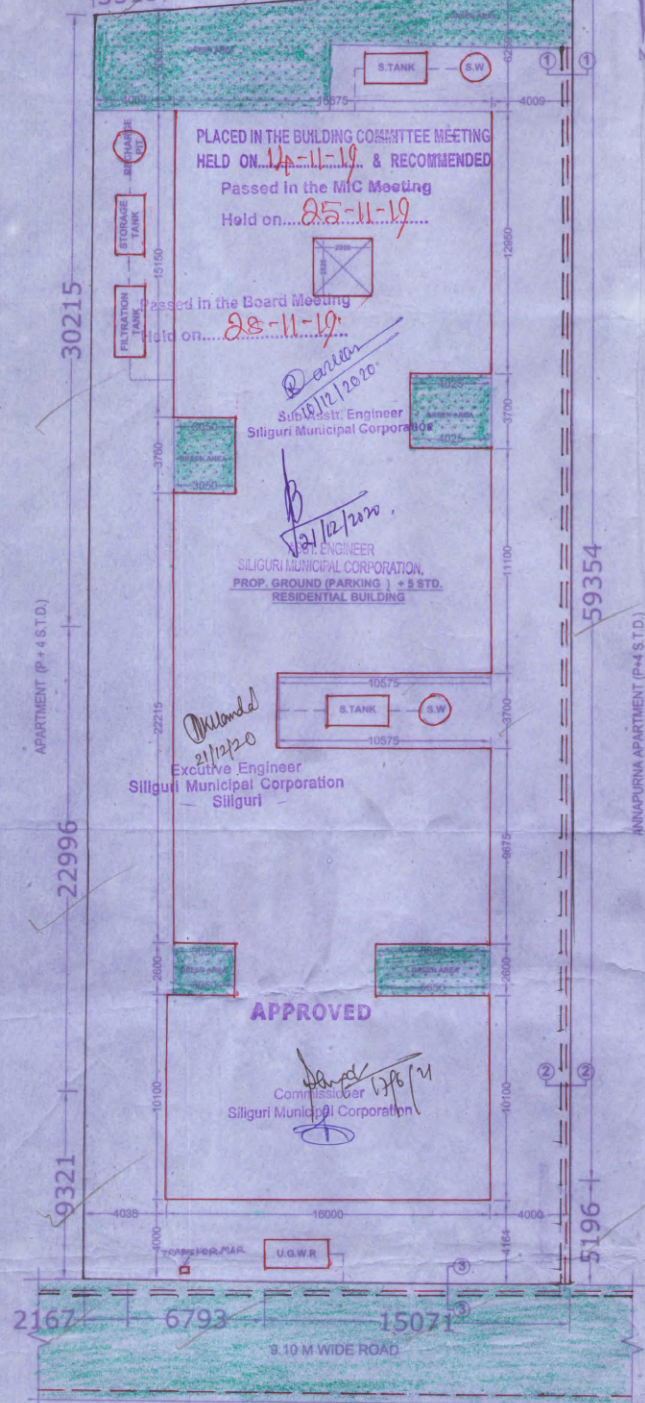

Manoj Kumar
B.Arch
Regd. No. CA/95/18822

SIGN. OF L.B.A.

Somendra Bhadra
Geo-Technical Engineer, Class-I
S.M.C. Empowerment Number-1-09
457, Bidhan Road, Siliguri
Ph. No. 97330-48915
e-mail - sbhadra65@gmail.com

SIGN. OF GEO.

ISHAANA DEVELOPERS
Partner

INDEX MAP

Location Plan
N.T.S.

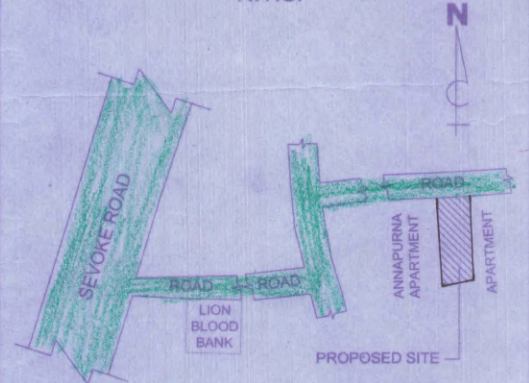

SCHEDULE OF LAND

MOUZA	- DABGRAM
PLOT NO.	- R.S. - 165 (F)
	- L.R. - 11 (P)
KHATIAN NO.	- R.S. - 82
	- L.R. - 478, 479, 480, 482
J.L. NO.	- 02
SHEET NO.	- 8 (R.S.) - 35 (L.R.)
P.S.	- BHAKTINAGAR
DIST.	- JALPAIGURI
WARD NO.	- 41 (S.M.C.)
HOLDING NO.	- 2542/1/N/A

AREA STATEMENT

LAND AREA (AS PER DEED)	: 1519.70 SQ.M.
LAND AREA (AS PER SITE)	: 1516.42 SQ.M.
PERM. GROUND COVERAGE	: 50 % OR 758.21 SQ.M.
PROP. GROUND COVERAGE	: 49.50 % OR 750.69 SQ.M.
AREA LEFT AS OPEN SPACE	: 755.73 SQ.M.
GROUND FLOOR AREA	: 750.69 SQ.M.
1ST FLOOR AREA	: 750.69 SQ.M.
2ND FLOOR AREA	: 750.69 SQ.M.
3RD FLOOR AREA	: 750.69 SQ.M.
4TH FLOOR AREA	: 750.69 SQ.M.
5TH FLOOR AREA	: 750.69 SQ.M.
TOTAL FLOOR AREA	: 4504.14 SQ.M.
PERM. F.A.R.	: 2.25
PROP. F.A.R.	: 2.05
NO. OF TENEMENTS	: 25 NOS
STAIR & LIFT AREA	: 109.85 SQ.M.
PERMISSIBLE HEIGHT OF THE BUILDING	: 40.00 M
PROPOSED HEIGHT OF THE BUILDING	: 18.450 M
USE OF THE BUILDING	: RESIDENTIAL
LUCR No- 3618/SJD A DATE- 28-08-2019	

GREEN AREA CALCULATION

TOTAL FLOOR AREA	= 4504.14 SQM.
TOTAL LAND AREA	= 1516.42 SQM.
TREE COVERED AREA REQUIRED	= 170.74 SQM. (11.26 %)
TREE COVERED AREA PROVIDED	= 171.50 SQM.

WASTE WATER DISCHARGE CALCULATION

THIS IS TO STATE THAT THE WASTE WATER RECYCLING SYSTEM WILL NOT BE REQUIRED FOR THE FOLLOWING HOUSING COMPLEX AS THE TOTAL WASTE WATER DISCHARGE